

 **LONCIN**



Inverter Generators & Generators





LC2000i / 2000i-S / 2000i-110V & LC3500i / 3500iO

	LC2000i / LC2000i-S* / LC2000i-S-110v - 1.6kW Rated	LC3500i - 3.0kW Rated	LC3500iO - 3.0kW Rated
Engine Type	Single Cylinder, 4 stroke, forced cooling OHV	Single Cylinder, 4 stroke, forced cooling OHV	Single Cylinder, 4 stroke, forced cooling OHV
Rated Output hp / (kW)	2.1 / (1.6)	4.0 / (3.0)	4.0 / (3.0)
Bore x Stroke (mm)	48.6 x 43	70 x 55	70 x 55
Displacement (cc)	79	212	212
Compression Ratio	9 : 1	8.5 : 1	8.5 : 1
Fuel Capacity (L)	4.2	10	9
Fuel Consumption (g/kW h)	≤ 395	≤ 395	≤ 395
Running Time (h)	7	11	9
Rated Frequency (Hz)	50	50	50
Rated Voltage (V)	230 / 110	230	230 / 110
Voltage Regulator System	FM-SPWM III	FM-SPWM III	FM-SPWM III
Rated Output (kW)	1.6	3.0	3.0
Max Output (kW)	1.8	3.3	3.3
Power Factor	1.0	1.0	1.0
DC Voltage (V)	12	12	12
DC Current (A)	8.3	8	8
Starting System	Recoil	Recoil / electric	Recoil
Ignition System	C.D.I	C.D.I	C.D.I
Noise (≤ 7m)	61dBA	65dBA	68dBA
Dimensions (L x W x H mm)	499 x 285 x 455	578 x 440 x 510	500 x 435 x 460
Net Weight (kg)	21	45	34
Oil Capacity (L)	0.35	0.6	0.6

*LC2000i-S can be synchronised with additional LC2000i-S inverters



LC2500-AS / LC3000-AS

	LC2500-AS - 2kW Rated	LC3000-AS - 2.3kW Rated
Engine Model	G200F/G200FD	
Engine Type	Single cylinder, 4 stroke, OHV 25° inclined, forced air cooling	
Net Power hp / (kW)	5.5 / 4.1	
Bore x Stroke (mm)	68 x 54	
Displacement (cc)	196	
Compression Ratio	8.5 : 1	
Oil Capacity (L)	0.6	
Fuel Tank Capacity (L)	18	
Fuel Consumption (g/kw h)	≤ 395	
Approx Running Time (h)	Dependant on load	
Rated Frequency (Hz)	50	
Rated Voltage (V)	110 / 230	
Voltage Regulator System	Automatic voltage regulation	
Sockets	2 x 16 amp	
Rated Output (kW)	2	2.3
Max Output (kW)	2.2	2.5
Power Factor	1.0	
DC Charging Voltage (V)	12 (DC)	
DC Charging Current (A)	8.3 (DC)	
Starting System	Recoil	
Ignition System	Transistorized magneto	
Noise (≤ 7m)	76dBA	76dBA
Dimensions (L x W x H mm)	590 x 475 x 460	680 x 540 x 545
Net Weight (kg)	43 / 45	52 / 54



LC5000D-AS / 6500D-AS / 8000D-AS

	LC5000D-A - 4kW Rated	LC6500D-A - 5kW Rated	LC8000D-A - 6kW Rated
Engine Model	G340F/G340FD	G390F/G390FD	G420F/G420FD
Engine Type	Single cylinder, 4 stroke, OHV 25° inclined, forced air cooling		
Net Power hp / (kW)	9.5 / 7.1	11 / 8.2	12 / 9.0
Bore x Stroke (mm)	82 x 64	88 x 64	90 x 66
Displacement (cc)	337	389	420
Compression Ratio	8.0 : 1		
Oil Capacity (L)	1.1		
Fuel Tank Capacity (L)	25		
Fuel Consumption (g/kW h)	≤ 374		
Approx Running Time (h)	10	9	8
Rated Frequency (Hz)	50		
Rated Voltage (V)	110 V / 230 V		
Voltage Regulator System	Automatic voltage regulation		
Sockets	3 x 32 amp		
Rated Output (kW)	4.0	5.0	6.0
Max Output (kW)	4.5	5.5	7.5
Power Factor	1.0		
DC Charging Voltage (V)	12 (DC)		
DC Charging Current (A)	8.3 (DC)		
Starting System	Recoil / Electric start		
Ignition System	Transistorized magneto		
Noise (≤ 7m)	76dBA		
Dimensions (L x W x H mm)	675 x 540 x 540	680 x 540 x 545	680 x 540 x 540
Net Weight (kg)	74	77 / 79	86 / 89

Typical Power Rating

1000 watts = 1.0 kW

1.25kVA = 1.0kW

Electrical Equipment	Approx wattage
Air Con 1hp	2500
Angle Grinder 125 mm	1100
Angle Grinder 230 mm	2200
Belt Sander	1100
Cement Mixer (Small)	1500
Central Heating Pump	800
Chainsaw	1600
Concrete Poker	2500
Cooker	12000 (minimum)
Computer and VDU	700
Coffee Machine	1300
Dehumidifier	3000
Deep Freeze	1500
Demolition Breaker	2400
Dishwasher	2000 - 3000
Fan Heater (2 bar)	2000
Fax Machine	600
Flood Light TH	500
Flood Light MH	1000
Fluorescent Tube	60
Floor Sander (200mm)	2000
Food Mixer	500
Fridge	700 - 1000
Hair Dryer	1500 - 2300
Hair Straighteners	150
Hammer Drill	1000
Hedge Trimmer	600
Hi-Fi	300
Hot Air Gun	3000

Electrical Equipment	Approx wattage
Iron	1000
Iron (Steam)	2200
Jigsaw	600
Kettle	2500 - 3000
Lawnmower	600 - 1200
Lawn Raker	500
Light Bulb (Domestic std)	25 - 100
Microwave 900W	1500
Orbital Sander	500
Planer	1000
Power Drill	500 - 900
Power Float	1500
Photocopier	1500
Pressure Washer	3000 - 6000
Printer	400
Radiator (Oil Filled)	1000 - 2000
Router	1600 - 1900
Saw (Chain)	1500
Saw 250mm (Masonry)	4000
Saw (Mitre)	1600
SAT / Cable TV Receiver	25
Strimmer	500
Television	200
Toaster	1050 - 1500
Treadmill (Domestic)	2300
Tumble Dryer	2500
Vacuum Cleaner	1000 - 1300
Washing Machine	4000
Water Heater	3000

Electric Motors	Running	Starting Watts
0.25 hp Motor	250	800
0.50 hp	500	1600
0.75 hp	750	2300
1.00 hp	1000	3000
1.50 hp	1500	4500
2.00 hp	2000	6000

This is an approximate guide only. Please consult the equipment manufacturer for precise wattage.
If in doubt, select next largest generator.

Water Pumps, Chemical Pumps & Semi Trash Pumps



Water Pumps

Why do you need a water pump?

Water pumps are a useful tool for a variety of residential, light commercial and agricultural tasks. A water pump is ideal for:

- Draining water from a basement
- Draining and filling your swimming pool, pond or hot tub
- Draining shallow flooded areas
- Irrigation purposes for agricultural or lawn sprinkling
- Distributing fertilizers and pesticides
- Various other tasks including construction purposes

How do I choose the right pumps for my needs?

When shopping for a water pump there are various items to consider. All water pumps are measured in discharge capacity (GPM), vertical suction lift, and maximum head lift.

Discharge Capacity is the rate of speed that water flows from the source to the discharge point, measured in litres per minute. It provides the power to move water quickly.

Vertical Suction Lift is the vertical distance from the water source to the pump. This is important for draining a basement or deep pond.

Maximum Head Lift is the total height from the source of the water to the destination or drainage point. This provides the power to move water over a distance.

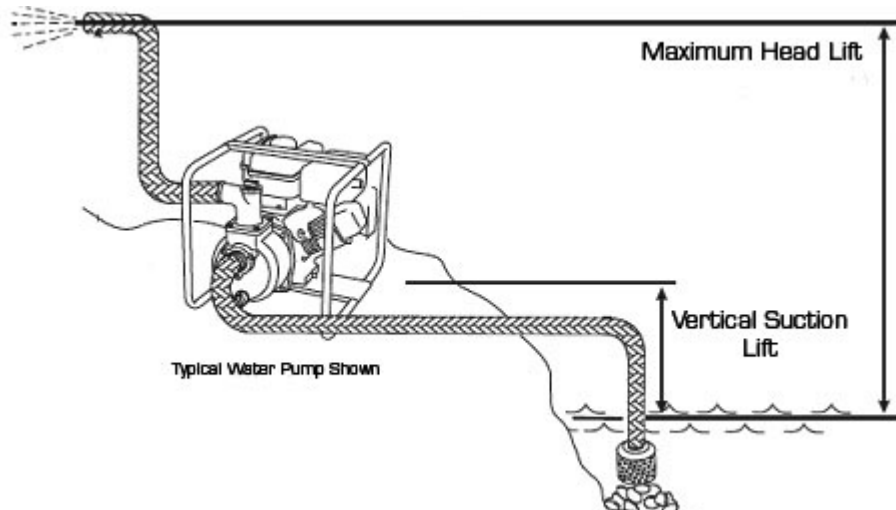



1" General Pump & 2" General Pump

	LC25ZB21-1.2Q - 1"	LC50ZB23-3.1Q - 2"
Pump		
Dia. of Discharge Port (mm)	25	50
Dia. of Suction Port (mm)	25	50
Lift (m)	21	23
Delivery Volume (litres/h)	8,000	30,000
Suction (m)	6	
Engine		
Engine Model	LC152F	G160F
Displacement (cc)	97	163
Net Power (hp)	1.6	4.8
Rated Speed (rpm)	3600	3600
Dimensions (mm)	380 x 300 x 370	550 x 430 x 390]
Net Weight (kg)	13	23



3" General Pump & 2" High Lift Pump

	LC80ZB35-4.5Q - 3"	LC50ZB60-4.5Q
Pump		
Dia. of Discharge Port (mm)	80	50
Dia. of Suction Port (mm)	80	50
Lift (m)	35	60
Delivery Volume (litres/h)	60,000	30,000
Suction (m)	6	
Engine		
Engine Model	G200F	
Displacement (cc)	196	
Net Power (hp)	5.5	
Rated Speed (rpm)	3600	
Dimensions (mm)	550 x 430 x 470	520 x 415 x 460
Net Weight (kg)	28	30.5



3" Semi Trash Pump

LC80WB30-4.5Q	
Pump	
Dia. of Discharge Port (mm)	80
Dia. of Suction Port (mm)	80
Lift (m)	30
Delivery Volume (litres/h)	45,000
Suction (m)	6
Engine	
Engine Model	G200F
Displacement (cc)	196
Net Power (hp)	5.5
Rated Speed (rpm)	3600
Dimensions (mm)	590 x 480 x 440
Net Weight (kg)	39

General Pump Flow Chart

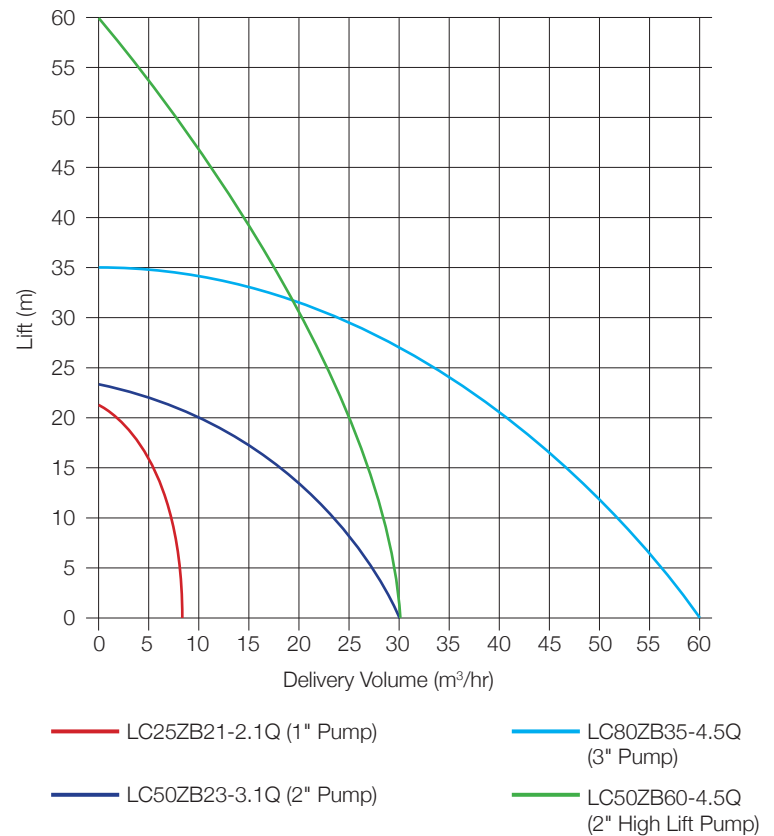

2" Chemical Pump

LC50HZB23-3.1Q	
Pump	
Dia. of Discharge Port (mm)	50
Dia. of Suction Port (mm)	50
Lift (m)	23
Delivery Volume (litres/h)	35,000
Suction (m)	6
Engine	
Engine Model	G160F
Displacement (cc)	163
Net Power (hp)	4.8
Rated Speed (rpm)	3600
Dimensions (mm)	550 x 430 x 470
Net Weight (kg)	25

Semi Trash / Chemical Pump Flow Chart

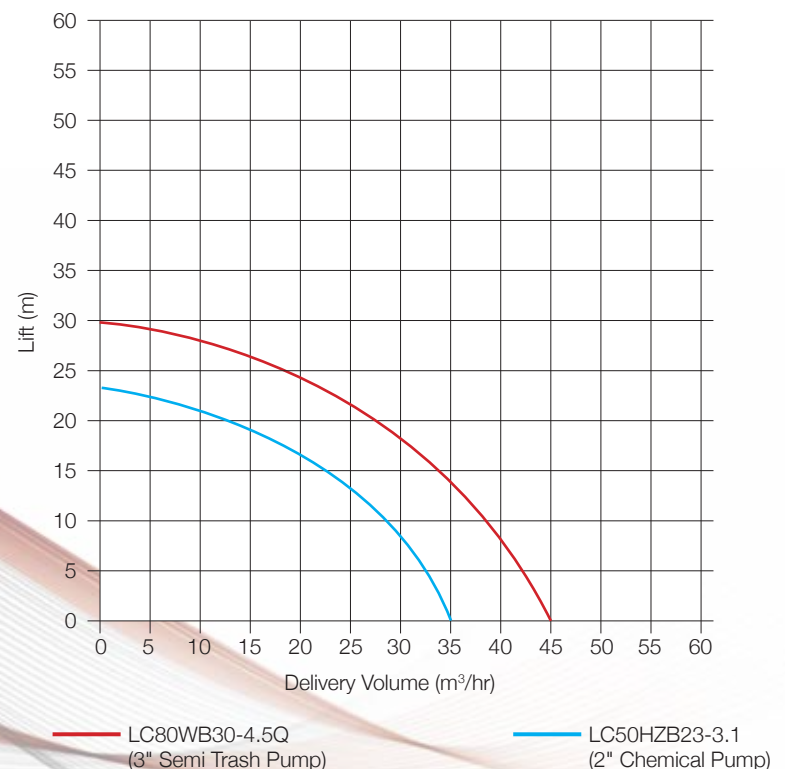

Vertical Engines

...think repower, think Loncin



3.6hp LC1P61FA



Engine Model	LC1P61FA
Engine Type	Single cylinder, 4-stroke, OHV, forced air cooling
Net Power (hp / kW)	3.6 / 2.7 @ 3600 r/min
Gross Power (hp / kW)	4.0 / 3.0 @ 3600 r/min
Net Torque (Nm)	7 @ 2500 r/min
Shaft Size	22.2 mm / 7/8"
Bore x Stroke (mm)	61 x 48
Displacement (cc)	140
Compression Ratio	9.4 : 1
Fuel Consumption (g/kw h)	≤ 395
Oil Consumption (g/kw h)	≤ 6.8
Idle Speed	1800 ± 150
Starting System	Recoil
Dimensions (L x W x H mm)	371 x 338 x 275
Net Weight (kg)	11.7

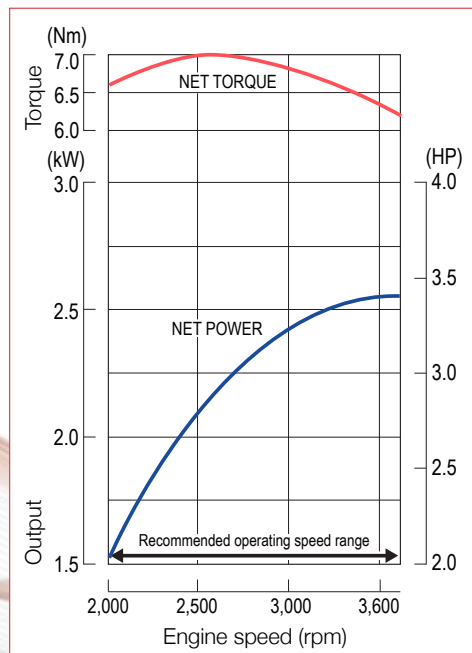
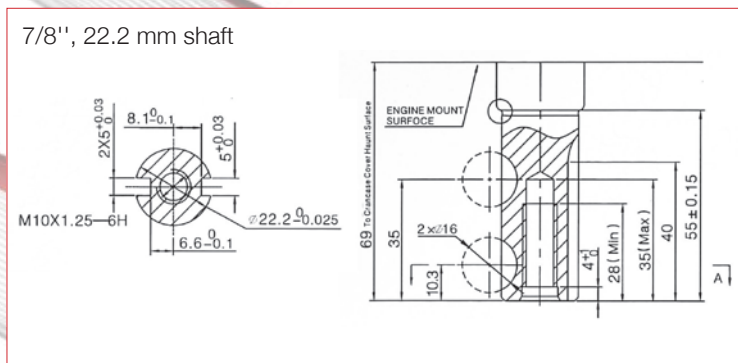
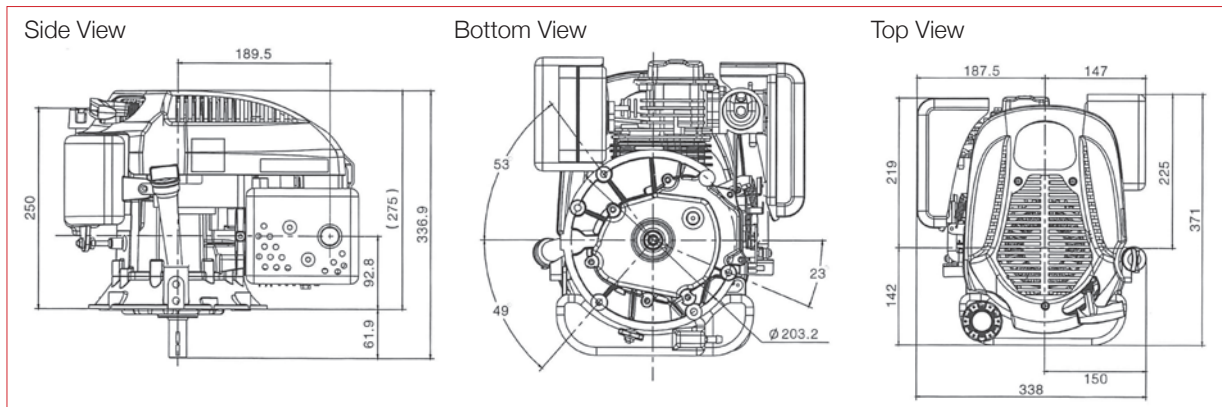

4hp LC1P65FA



Engine Model	LC1P65FA
Engine Type	Single cylinder, 4-stroke, OHV, forced air cooling
Net Power (hp / kW)	4.0 / 3.0 @ 3600 r/min
Gross Power (hp / kW)	5.0 / 3.7 @ 3600 r/min
Net Torque (Nm)	8.3 @ 2500 r/min
Shaft Size	22.2 mm / 7/8"
Bore x Stroke (mm)	65 x 48
Displacement (cc)	159
Compression Ratio	9.2 : 1
Fuel Consumption (g/kw h)	≤ 395
Oil Consumption (g/kw h)	≤ 6.8
Idle Speed	1800 ± 150
Starting System	Recoil
Dimensions (L x W x H mm)	371 x 338 x 275
Net Weight (kg)	11.8

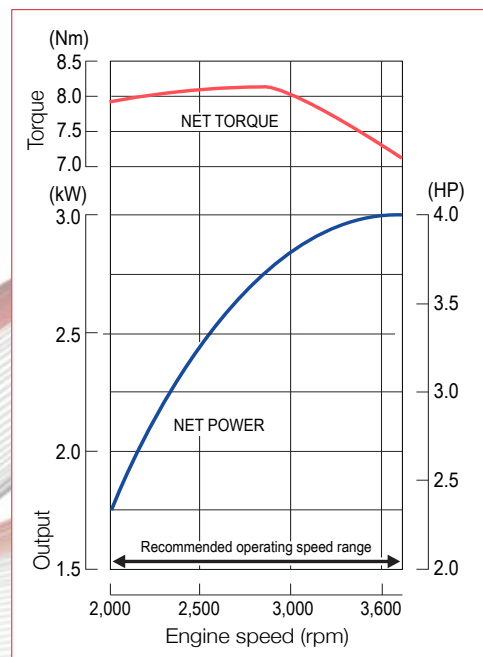
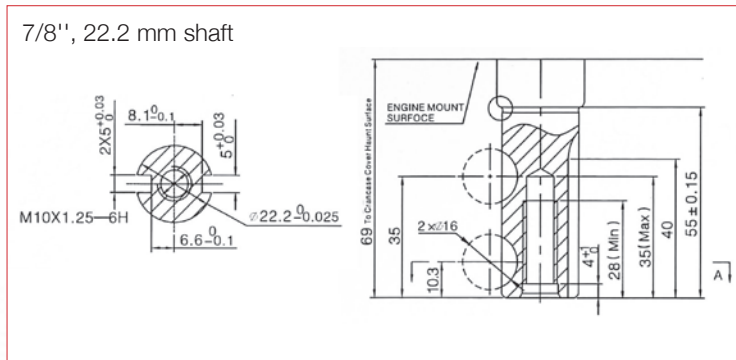
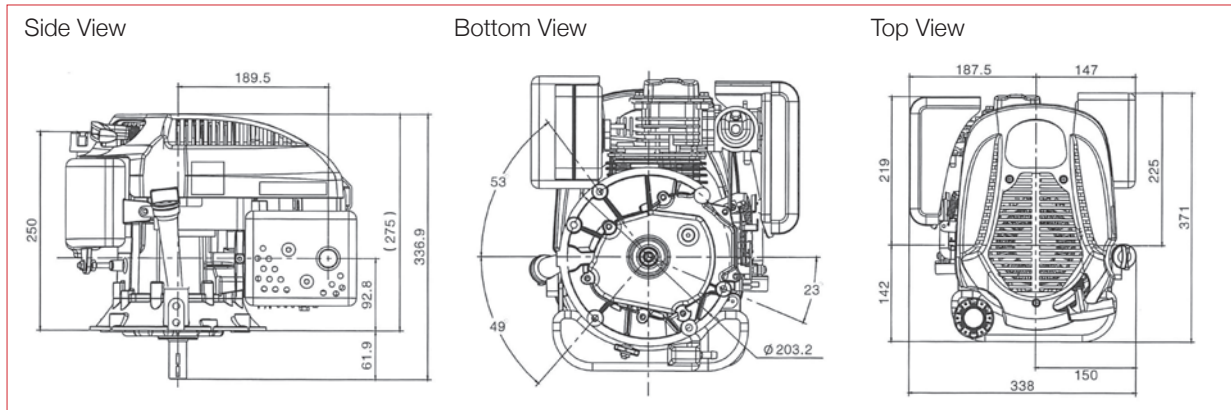

4.8hp LC1P70FA



Engine Model	LC1P70FA
Engine Type	Single cylinder, 4-stroke, OHV, forced air cooling
Net Power (hp / kW)	4.8 / 3.6 @ 3600 r/min
Gross Power (hp / kW)	6.0 / 4.5 @ 3600 r/min
Net Torque (Nm)	10.5 @ 2500 r/min
Shaft Size	22.2 mm / 7/8"
Bore x Stroke (mm)	70 x 51
Displacement (cc)	196
Compression Ratio	8.9 : 1
Fuel Consumption (g/kw h)	≤ 395
Oil Consumption (g/kw h)	≤ 6.8
Idle Speed	1800 ± 150
Starting System	Recoil
Dimensions (L x W x H mm)	385 x 358 x 278
Net Weight (kg)	12.8

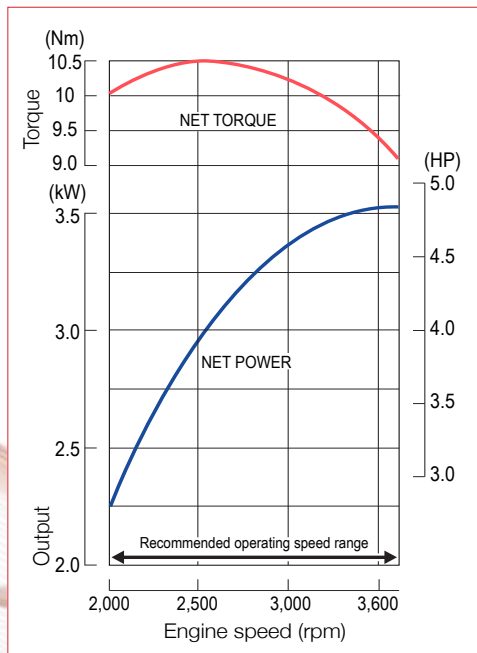
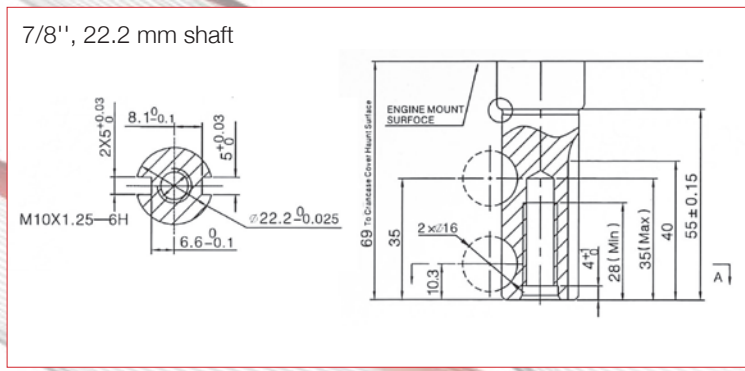
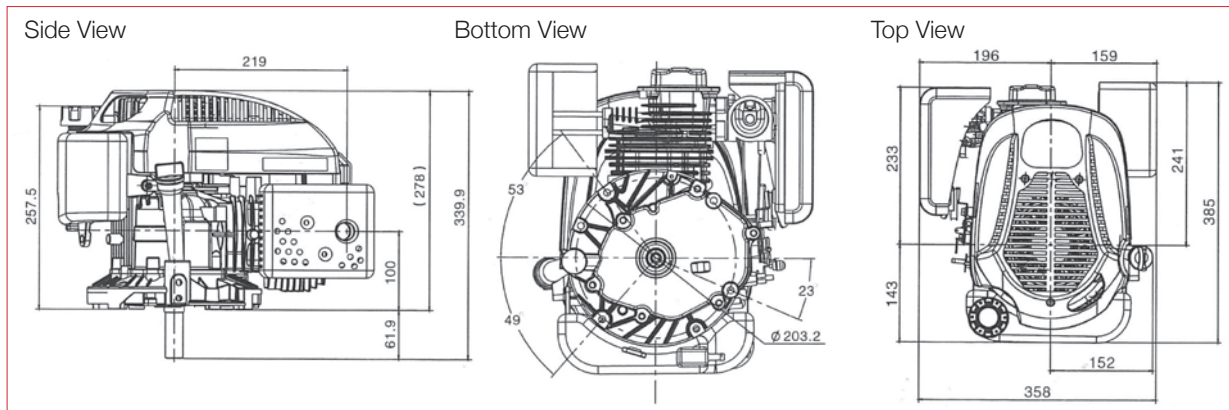

19.3hp LC2P80F



Engine Model	LC2P80F
Engine Type	V-twin, 4-stroke, OHV, forced air cooling
Net Power (hp / kW)	19.3 / 14.4 @ 3600 r/min
Gross Power (hp / kW)	25 / 18.65 @ 3600 r/min
Net Torque (Nm)	48 @ 2400 r/min
Shaft Size	25.4 mm / 1"
Bore x Stroke (mm)	80 x 76
Displacement (cc)	764
Compression Ratio	8.7 : 1
Fuel Consumption (g/kw h)	≤ 379
Idle Speed	1650 ± 100
Starting System	Electric start
Dimensions (L x W x H mm)	466 x 480 x 356
Net Weight (kg)	42

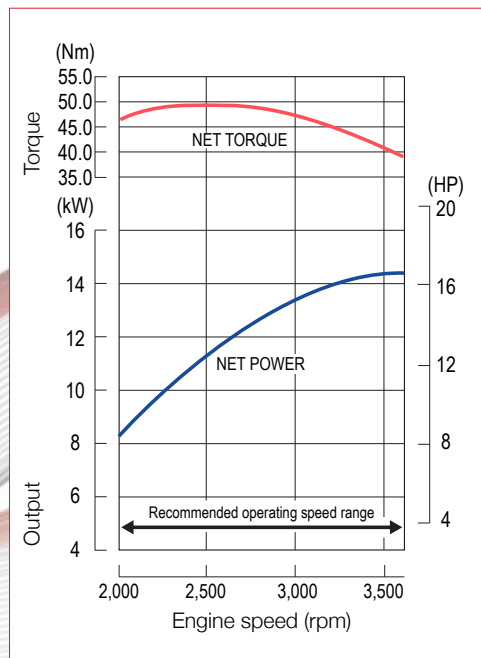
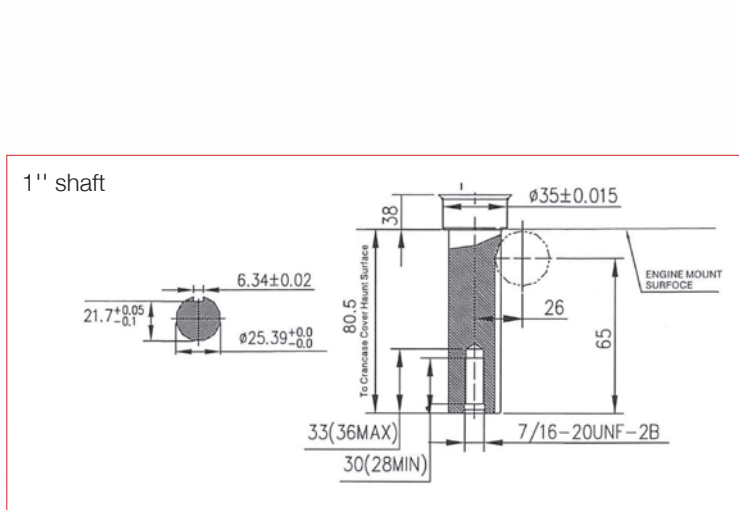
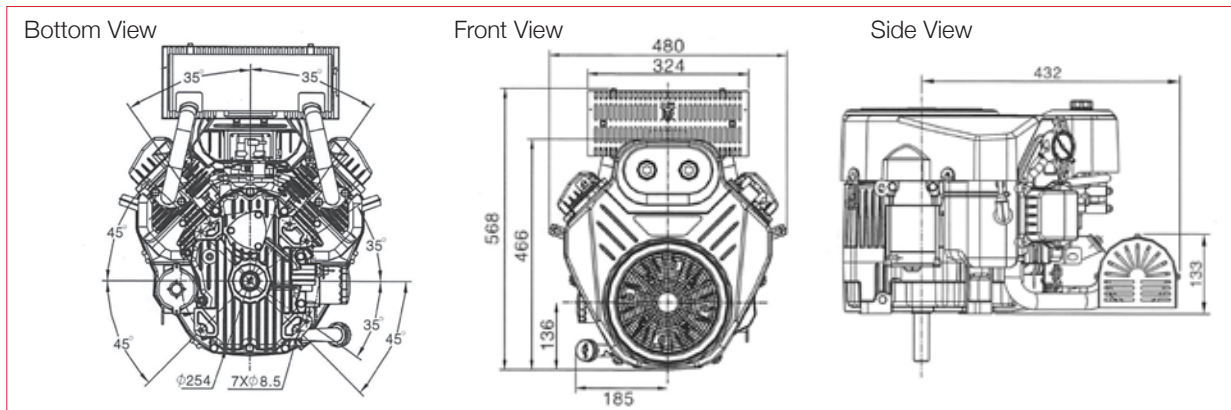

Horizontal Engines

...think repower, think Loncin



1.8hp LC152F



Engine Model	LC152F
Engine Type	Single cylinder, 4-stroke, forced air cooled
Net Power (hp / kW)	1.8 / 1.35 @ 3600 r/min
Gross Power (hp / kW)	2.5 / 1.86 @ 3600 r/min
Net Torque (Nm)	3.3 @ 3000 r/min
Bore x Stroke (mm)	52 x 46
Displacement (cc)	97
Compression Ratio	5.6 : 1
Oil Capacity (L)	0.45
Fuel Consumption (g/kw h)	≤ 450
Oil Consumption (g/kw h)	≤ 6.8
Idle Speed	1700 ± 150
Starting System	Recoil
Noise (≤ 7m)	70dBA
Dimensions (L x W x H mm)	280 x 270 x 345
Net Weight (kg)	9

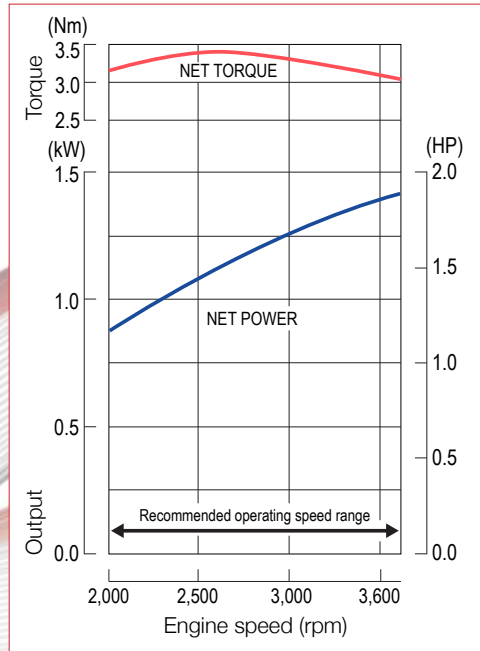
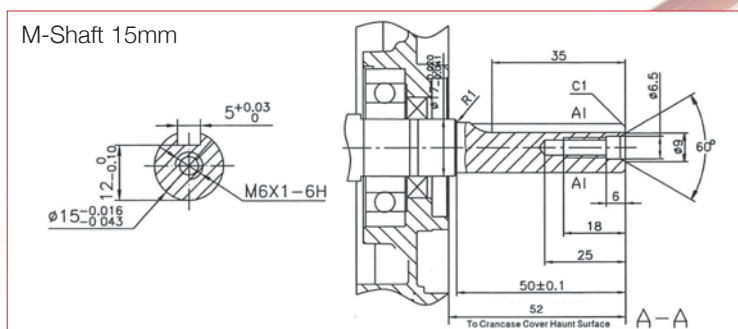
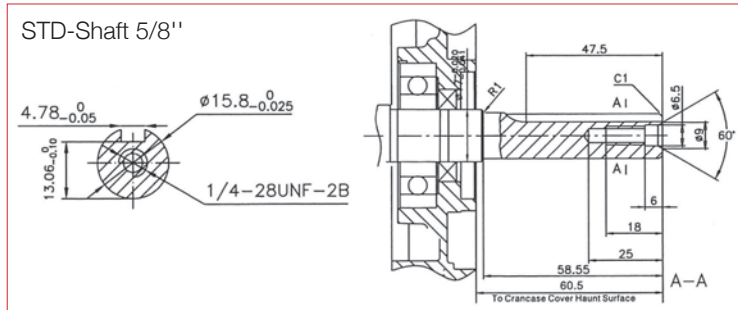
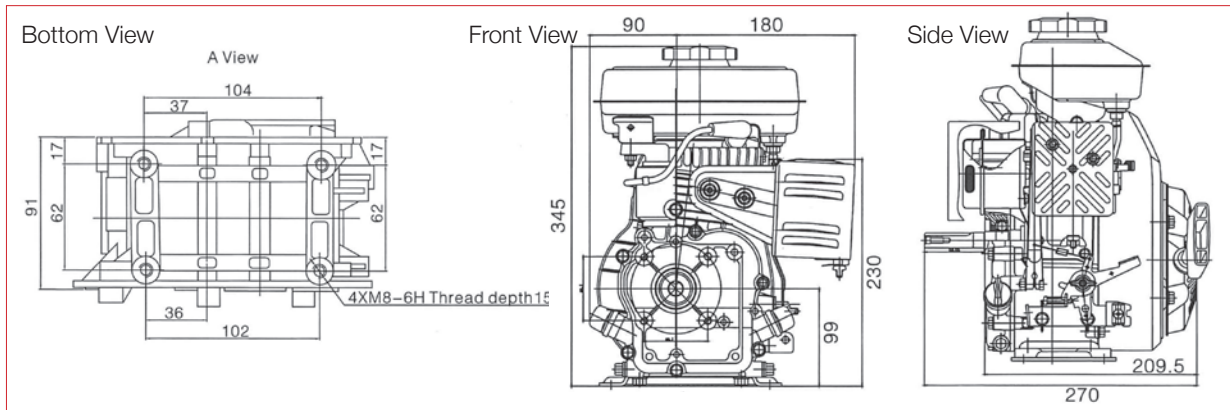

2.1hp LC154F



Engine Model	LC154F
Engine Type	Single cylinder, 4-stroke, OHV, forced air cooling
Net Power (hp / kW)	2.1 / 1.6 @ 3600 r/min
Gross Power (hp / kW)	2.8 / 2.1 @ 3600 r/min
Net Torque (Nm)	4.5 @ 3000 r/min
Bore x Stroke (mm)	54 x 38
Displacement (cc)	87
Compression Ratio	8.0 : 1
Oil Capacity (L)	0.45
Fuel Consumption (g/kw h)	≤ 450
Oil Consumption (g/kw h)	≤ 6.8
Idle Speed	1700 ± 150
Starting System	Recoil
Noise (≤ 7m)	70dBA
Dimensions (L x W x H mm)	310 x 260 x 305
Net Weight (kg)	9

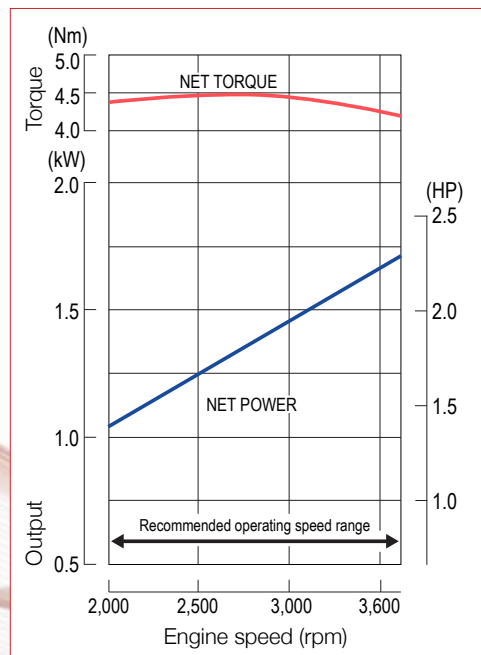
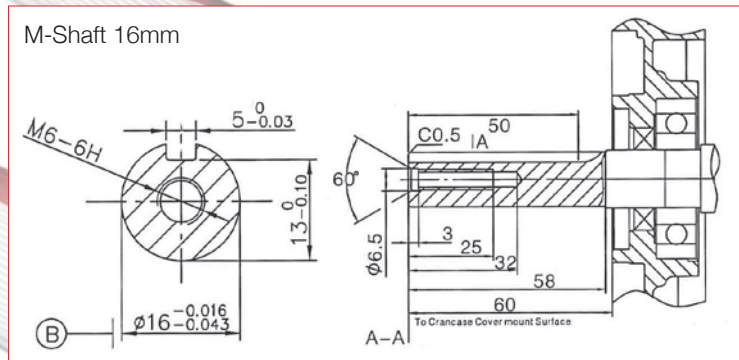
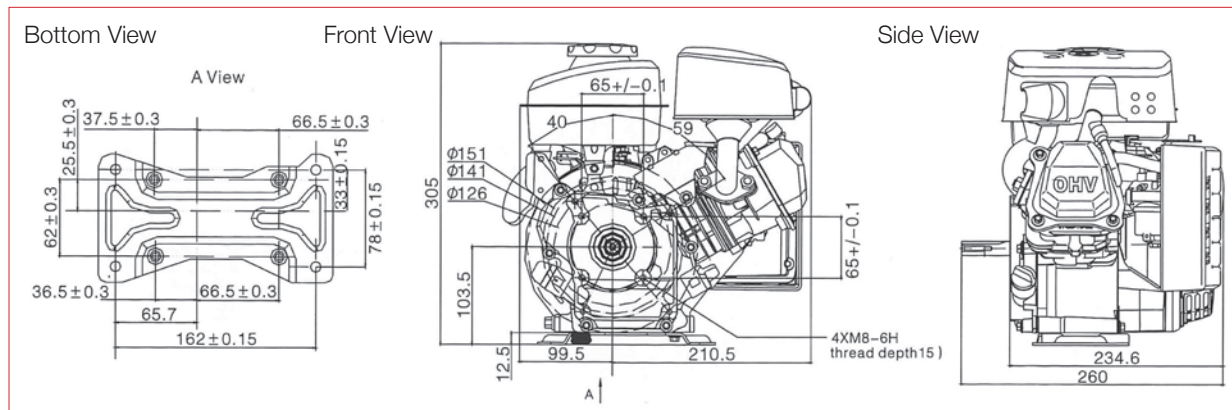

3.5hp G120F



Engine Model	G120F
Engine Type	Single cylinder, 4-stroke, OHV, forced air cooling
Net Power (hp / kW)	3.5 / 2.6 @ 3600 r/min
Gross Power (hp / kW)	4.0 / 3.0 @ 3600 r/min
Net Torque (Nm)	7.3 @ 2500 r/min
Bore x Stroke (mm)	60 x 42
Displacement (cc)	118
Compression Ratio	8.5 : 1
Oil Capacity (L)	0.6
Fuel Consumption (g/kw h)	≤ 395
Oil Consumption (g/kw h)	≤ 6.8
Idle Speed	1450 ± 150
Starting System	Recoil
Noise (≤ 7m)	70dBA
Dimensions (L x W x H mm)	341 x 305 x 318
Net Weight (kg)	13

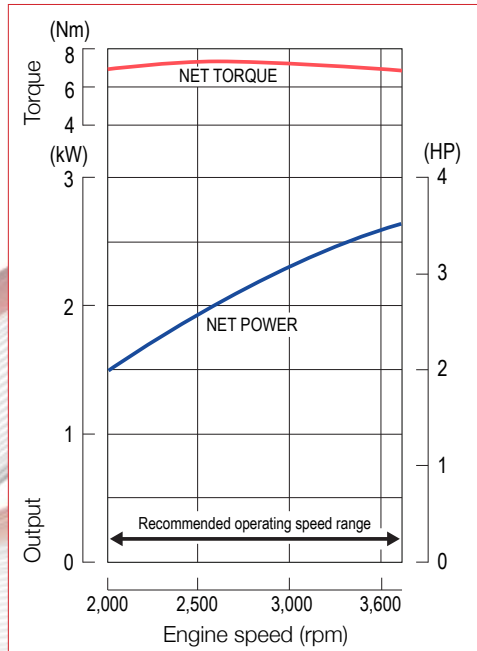
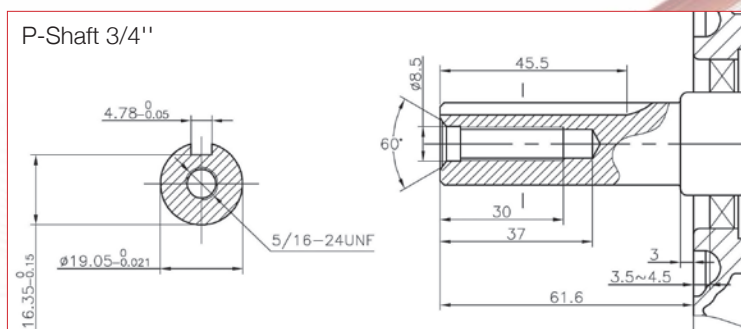
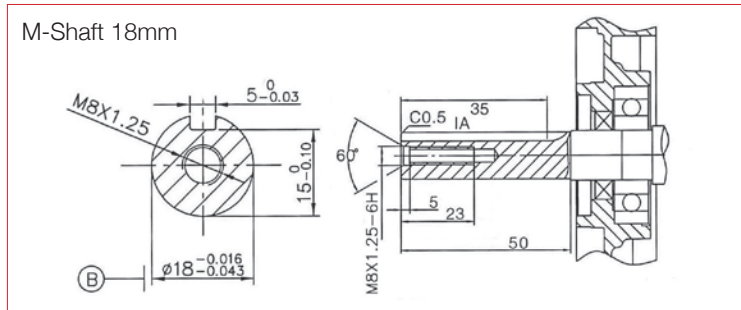
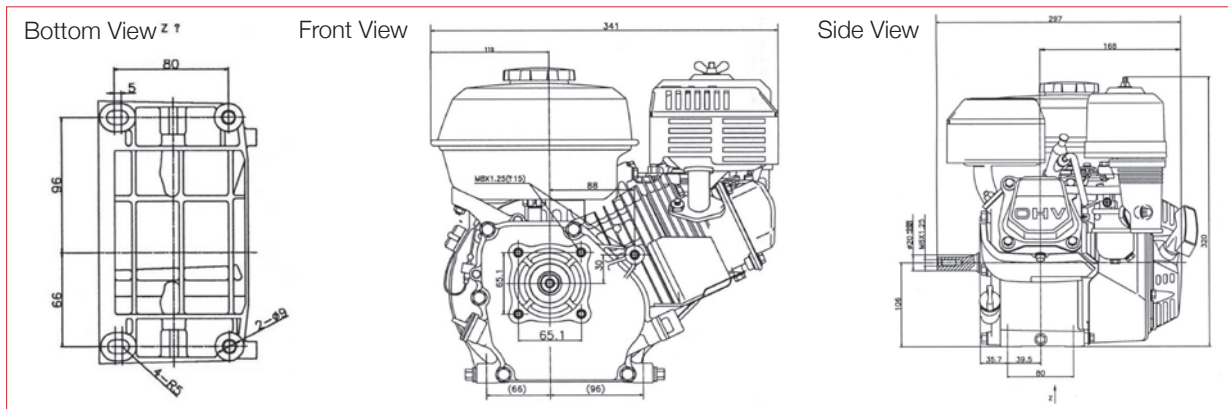

4.8hp G160F



Engine Model	G160F
Engine Type	Single cylinder, 4-stroke, OHV, forced air cooling
Net Power (hp / kW)	4.8 / 3.6 @ 3600 r/min
Gross Power (hp / kW)	5.5 / 4.1 @ 3600 r/min
Net Torque (Nm)	10.3 @ 2500 r/min
Bore x Stroke (mm)	68 x 45
Displacement (cc)	163
Compression Ratio	8.5 : 1
Oil Capacity (L)	0.6
Fuel Consumption (g/kw h)	≤ 395
Oil Consumption (g/kw h)	≤ 6.8
Idle Speed	1450 ± 150
Starting System	Recoil
Noise (≤ 7m)	70dB(A)
Dimensions (L x W x H mm)	362 x 312 x 335
Net Weight (kg)	15

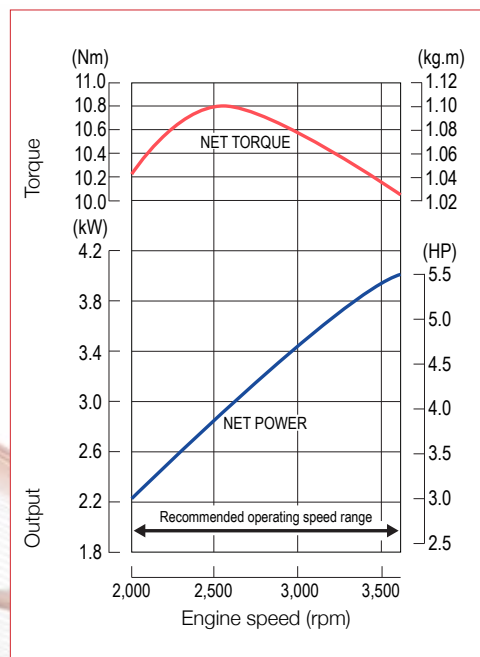
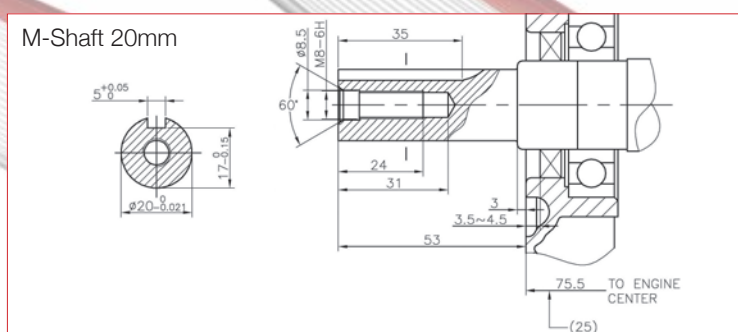
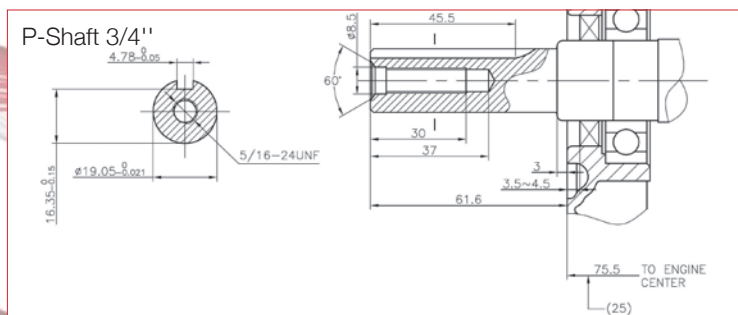
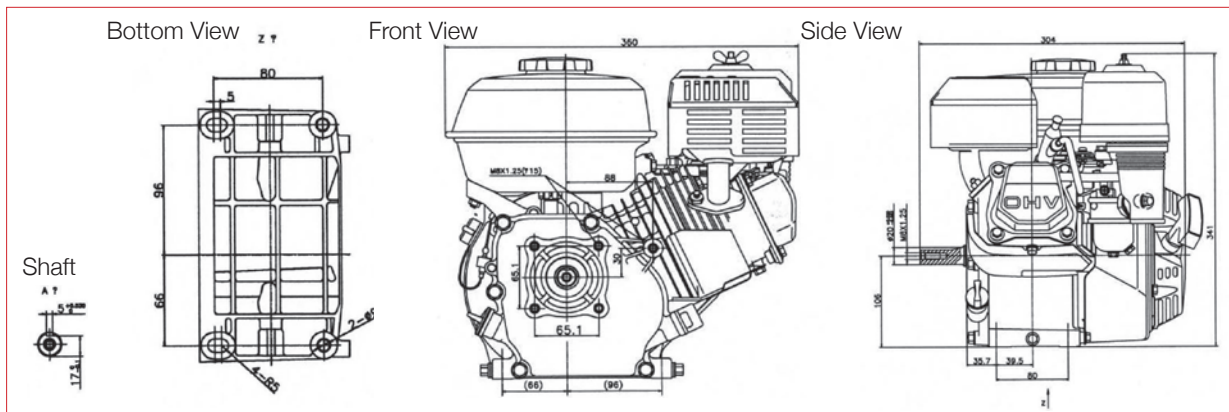

5.5hp G200F



Engine Model	G200F
Engine Type	Single cylinder, 4-stroke, OHV, forced air cooling
Net Power (hp / kW)	5.5 / 4.1 @ 3600 r/min
Gross Power (hp / kW)	6.5 / 4.85 @ 3600 r/min
Net Torque (Nm)	12.4 @ 2500 r/min
Bore x Stroke (mm)	68 x 54
Displacement (cc)	196
Compression Ratio	8.5 : 1
Oil Capacity (L)	0.6
Fuel Consumption (g/kw h)	≤ 395
Oil Consumption (g/kw h)	≤ 6.8
Idle Speed	1450 ± 150
Starting System	Recoil / Electric start optional
Noise (≤ 7m)	70dBA
Dimensions (L x W x H mm)	376 x 312 x 335
Net Weight (kg)	16

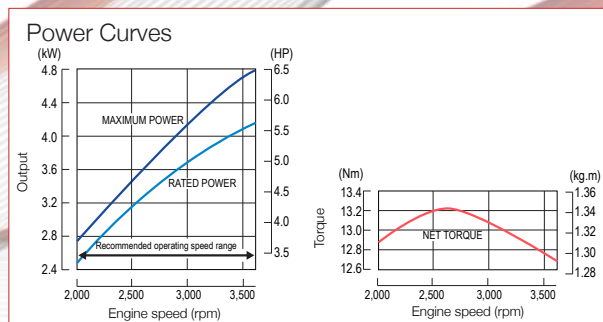
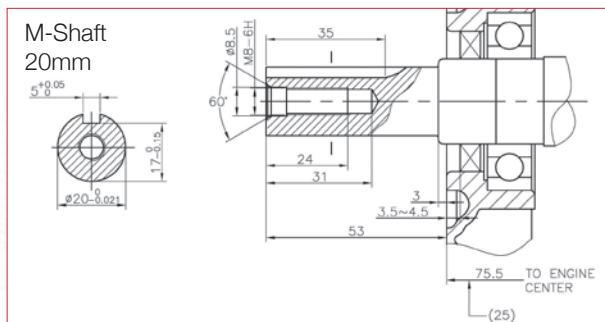
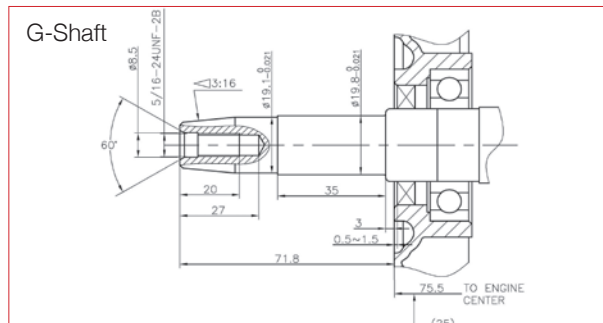
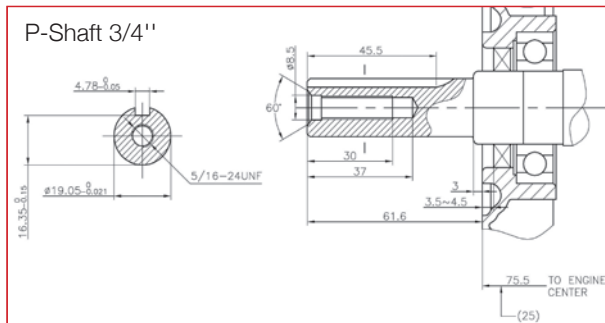
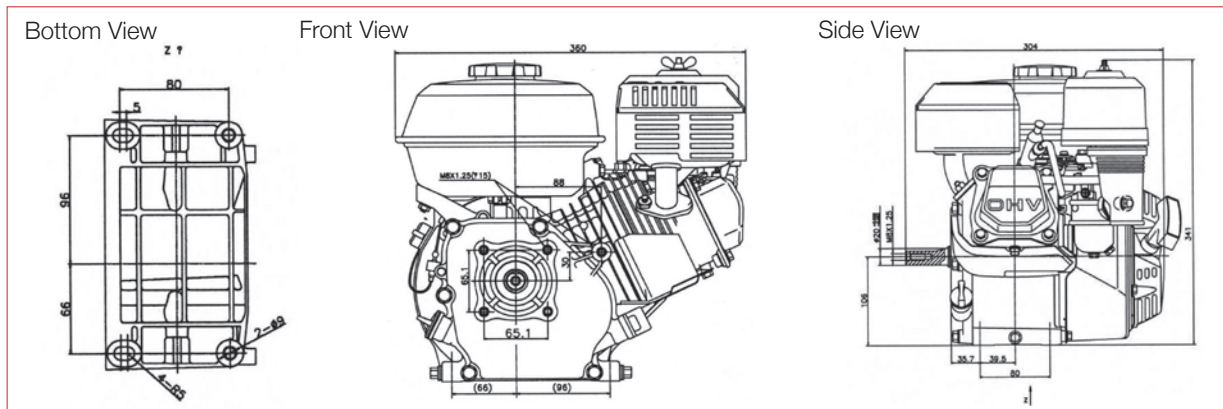

7hp G240F



Engine Model	G240F
Engine Type	Single cylinder, 4-stroke, OHV, forced air cooling
Net Power (hp / kW)	7.0 / 5.2 @ 3600 r/min
Gross Power (hp / kW)	8.0 / 6.0 @ 3600 r/min
Net Torque (Nm)	15.1 @ 2500 r/min
Bore x Stroke (mm)	73 x 58
Displacement (cc)	242
Compression Ratio	8.2 : 1
Oil Capacity (L)	0.95
Fuel Consumption (g/kw h)	≤ 374
Oil Consumption (g/kw h)	≤ 6.8
Idle Speed	1450 ± 150
Starting System	Recoil
Noise (≤ 7m)	70dBA
Dimensions (L x W x H mm)	430 x 380 x 410
Net Weight (kg)	24.5

Bottom View

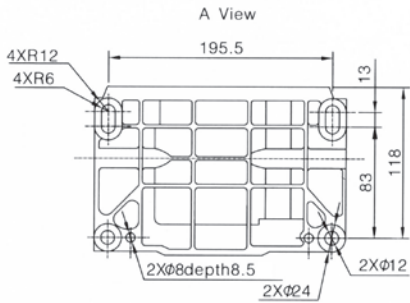

Top View

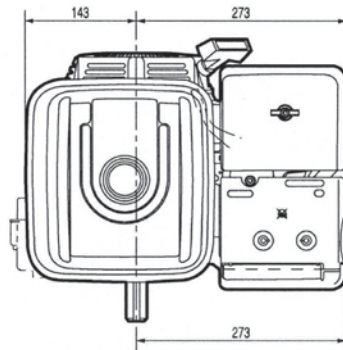

Side View

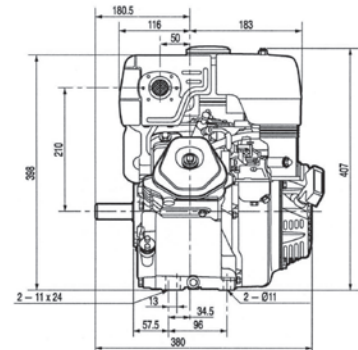

P-Shaft 1"

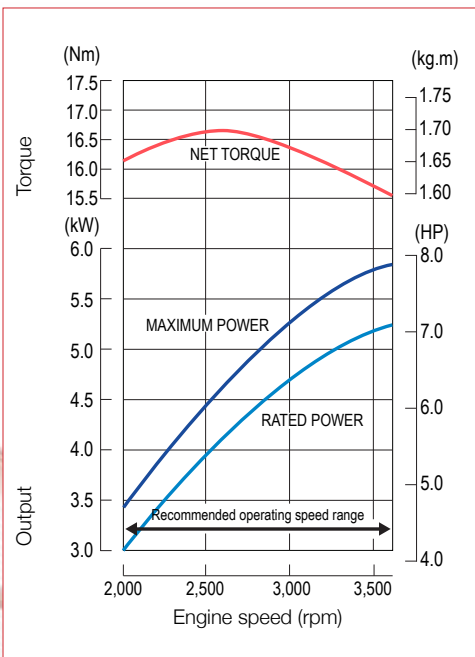
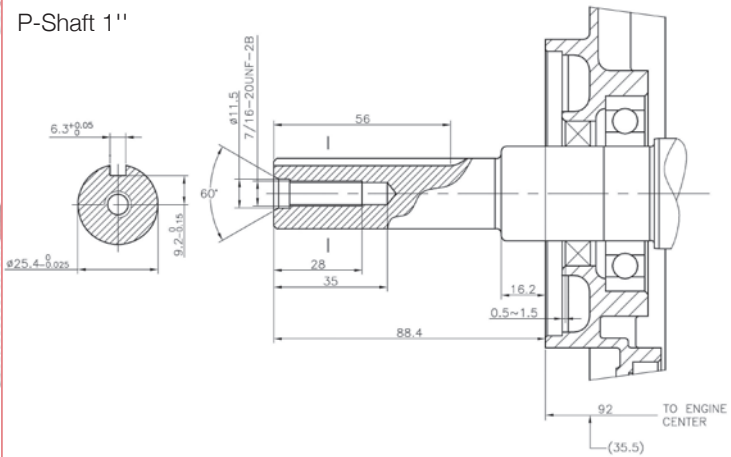

8hp G270F



Engine Model	G270F
Engine Type	Single cylinder, 4-stroke, OHV, forced air cooling
Net Power (hp / kW)	8.0 / 6.0 @ 3600 r/min
Gross Power (hp / kW)	9.0 / 6.7 @ 3600 r/min
Net Torque (Nm)	16.3 @ 2500 r/min
Bore x Stroke (mm)	77 x 58
Displacement (cc)	270
Compression Ratio	8.1 : 1
Oil Capacity (L)	0.95
Fuel Consumption (g/kw h)	≤ 374
Oil Consumption (g/kw h)	≤ 6.8
Idle Speed	1450 ± 150
Starting System	Recoil / Electric start optional
Noise (≤ 7m)	70dBA
Dimensions (L x W x H mm)	430 x 380 x 410
Net Weight (kg)	25

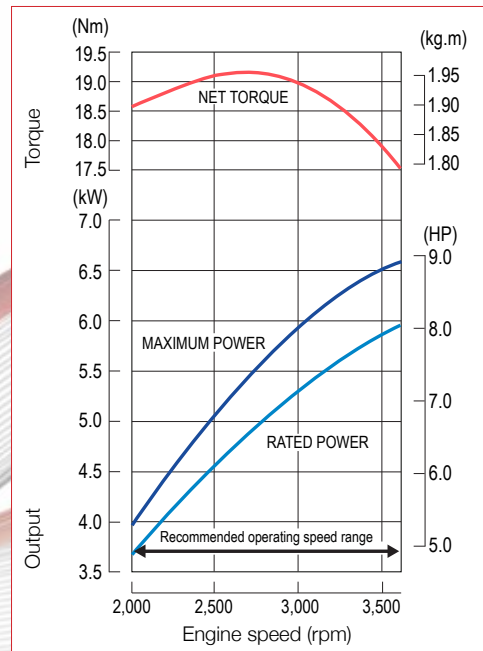
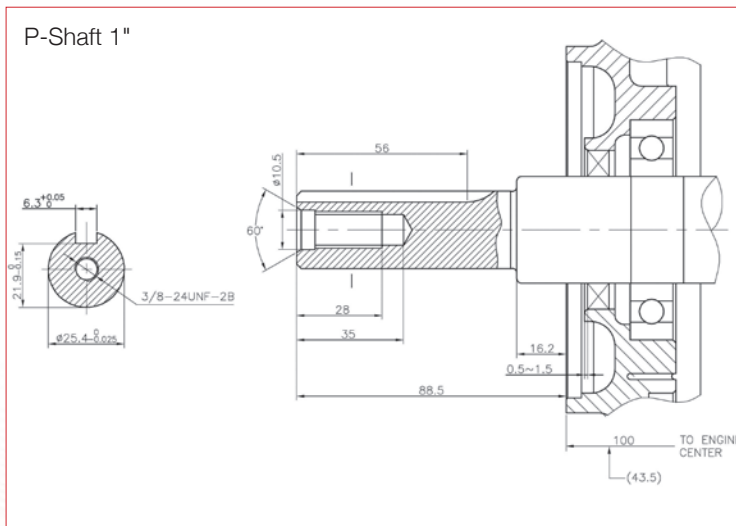
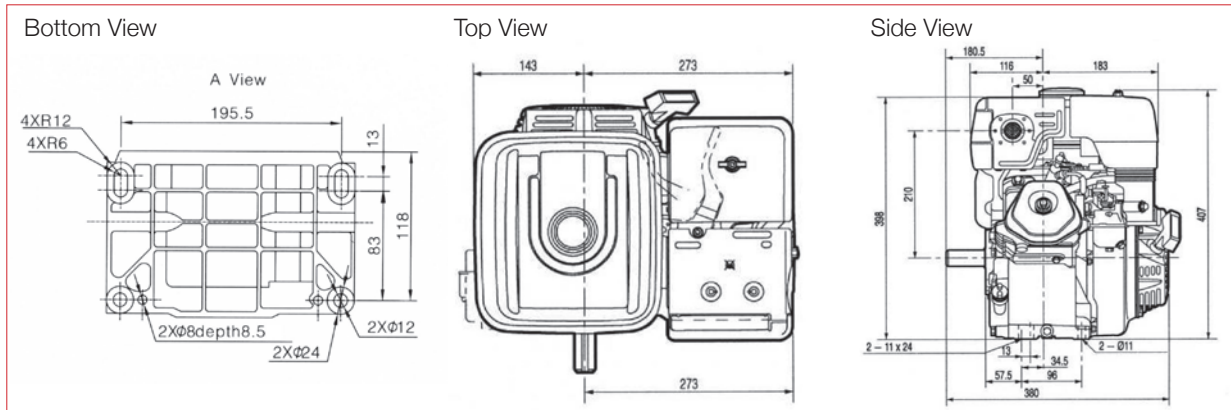

10hp G340F



Engine Model	G340F
Engine Type	Single cylinder, 4-stroke, OHV, forced air cooling
Net Power (hp / kW)	10 / 7.1 @ 3600 r/min
Gross Power (hp / kW)	11 / 8.2 @ 3600 r/min
Net Torque (Nm)	21.6 @ 2500 r/min
Bore x Stroke (mm)	82 x 64
Displacement (cc)	337
Compression Ratio	8 : 1
Oil Capacity (L)	1.1
Fuel Consumption (g/kw h)	≤ 374
Oil Consumption (g/kw h)	≤ 6.8
Idle Speed	1450 ± 150
Starting System	Recoil / Electric start optional
Noise (≤ 7m)	70dBA
Dimensions (L x W x H mm)	450 x 405 x 443
Net Weight (kg)	31

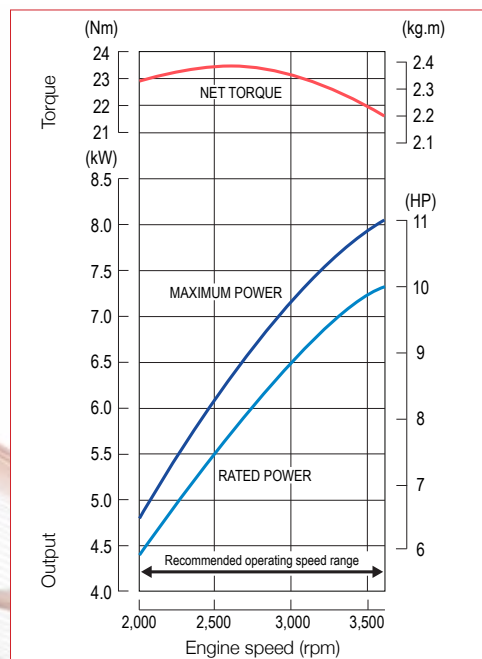
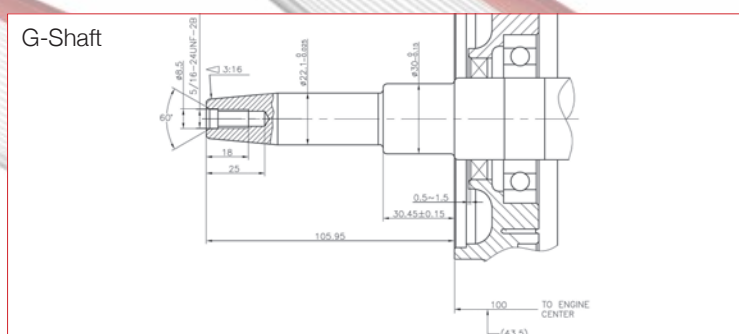
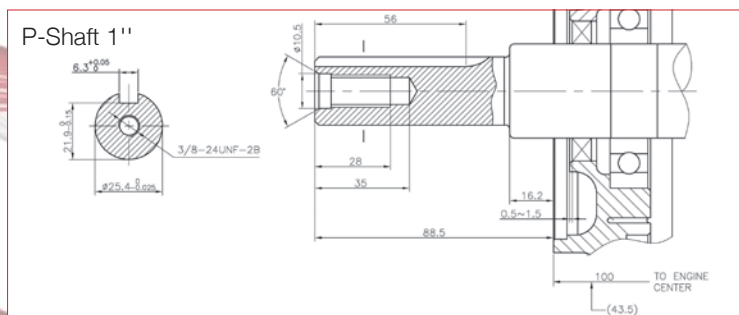
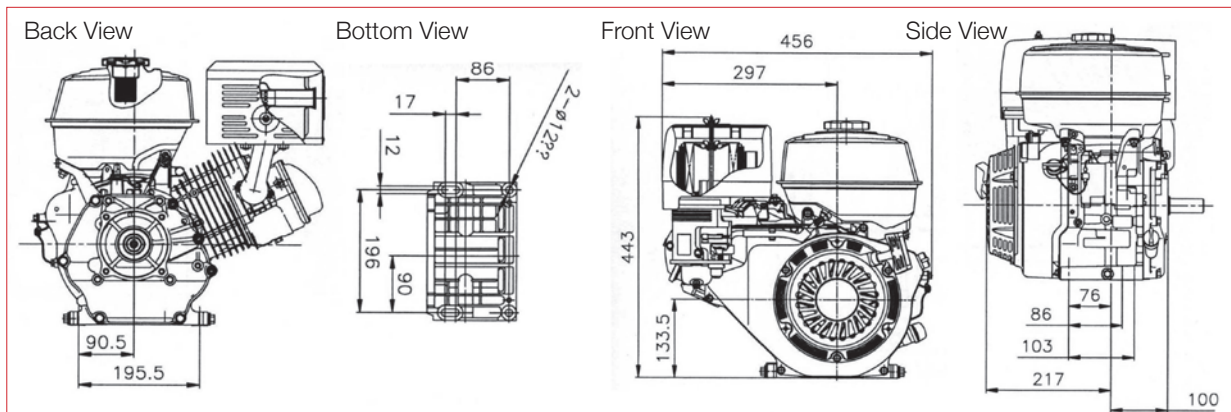

11hp G390F



Engine Model	G390F
Engine Type	Single cylinder, 4-stroke, OHV, forced air cooling
Net Power (hp / kW)	11 / 8.2 @ 3600 r/min
Gross Power (hp / kW)	13 / 9.7 @ 3600 r/min
Net Torque (Nm)	25.1 @ 2500 r/min
Bore x Stroke (mm)	88 x 64
Displacement (cc)	389
Compression Ratio	8 : 1
Oil Capacity (L)	1.1
Fuel Consumption (g/kw h)	≤ 374
Oil Consumption (g/kw h)	≤ 6.8
Idle Speed	1450 ± 150
Starting System	Recoil / Electric start optional
Noise (≤ 7m)	70dBA
Dimensions (L x W x H mm)	450 x 405 x 443
Net Weight (kg)	31

Front View

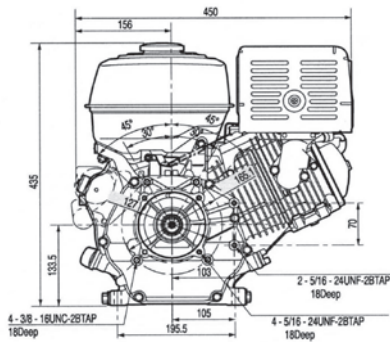

Bottom View

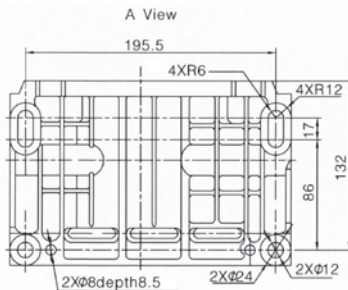

Side View

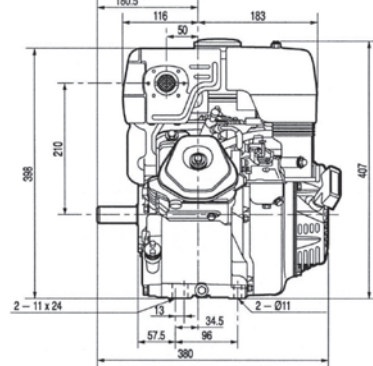

P-Shaft 1"

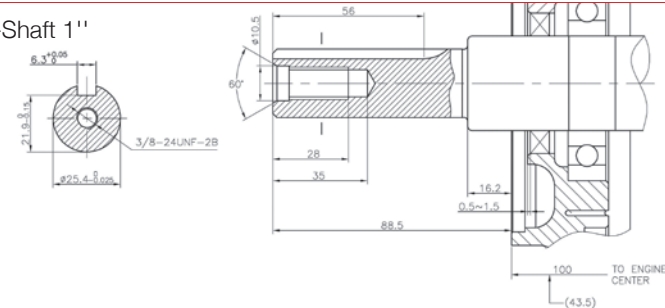

G-Shaft

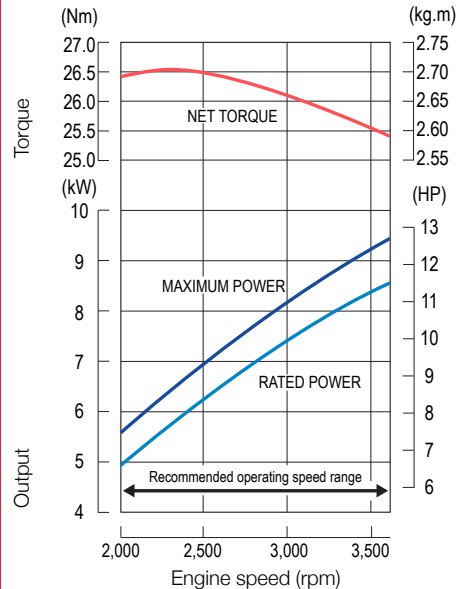
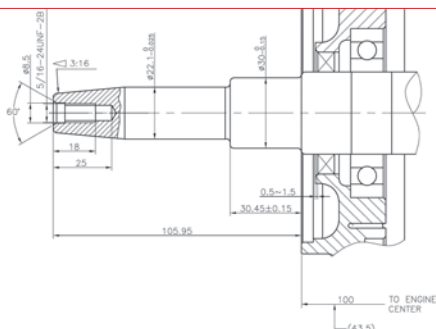

19.7hp V-Twin



Engine Model	LC2V78FD-1
Engine Type	V-Twin, 4-stroke, OHV, forced air cooling
Net Power (hp / kW)	19.7 / 14.7 @ 3600 r/min
Gross Power (hp / kW)	22 / 16.4 @ 3600 r/min
Net Torque (Nm)	43.5 @ 2500 r/min
Bore x Stroke (mm)	78 x 71
Displacement (cc)	678
Compression Ratio	8.5 : 1
Oil Capacity (L)	1.5
Fuel Consumption (g/kw h)	≤ 360
Idle Speed	1500 ± 150
Starting System	Electric
Dimensions (L x W x H mm)	510 x 400 x 450
Net Weight (kg)	43

Front View

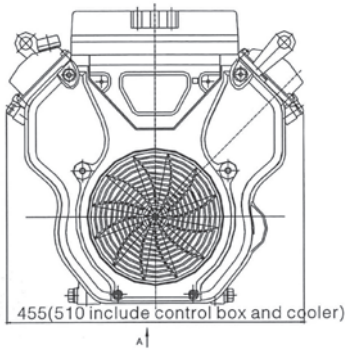

Side View

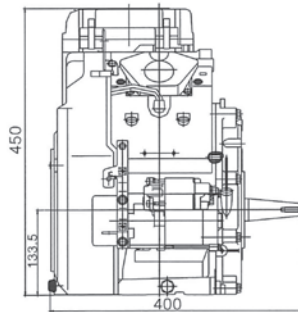

Bottom View

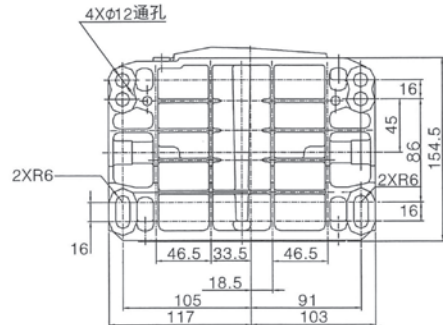

P-Shaft 1"

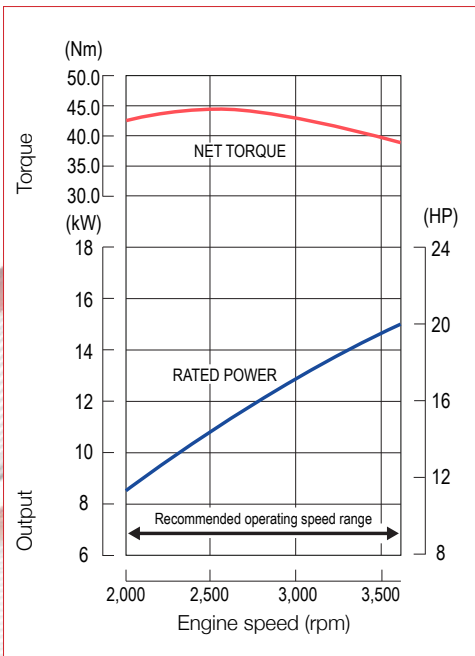
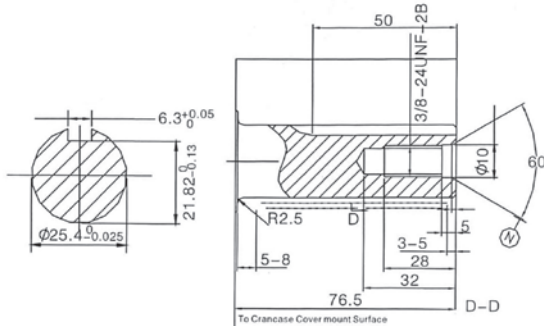

29.5hp V-Twin



Engine Model	LC2V90FD-1
Engine Type	V-Twin, 4-stroke, OHV, forced air cooling
Net Power (hp / kW)	29.5 / 22 @ 3600 r/min
Net Torque (Nm)	70 @ 2500 r/min
Bore x Stroke (mm)	90 x 78.5
Displacement (cc)	999
Compression Ratio	8.5 : 1
Oil Capacity (L)	2.5
Fuel Consumption (g/kw h)	
Idle Speed	1800 ± 150
Starting System	Electric start
Dimensions (L x W x H mm)	568 x 505 x 685
Net Weight (kg)	60

Front View

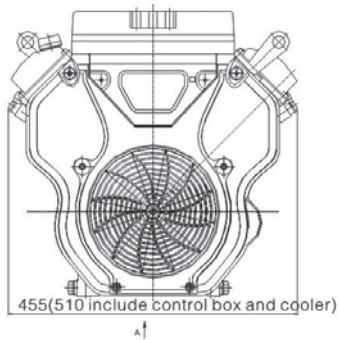

Side View

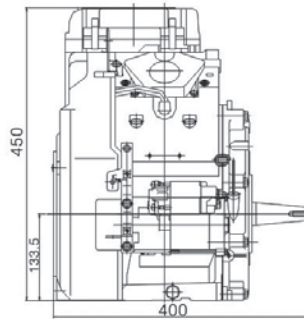

Bottom View

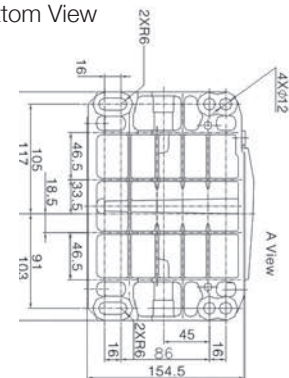

G-Shaft

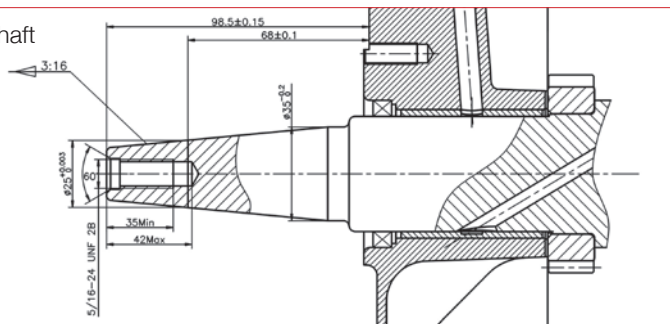

P- Shaft

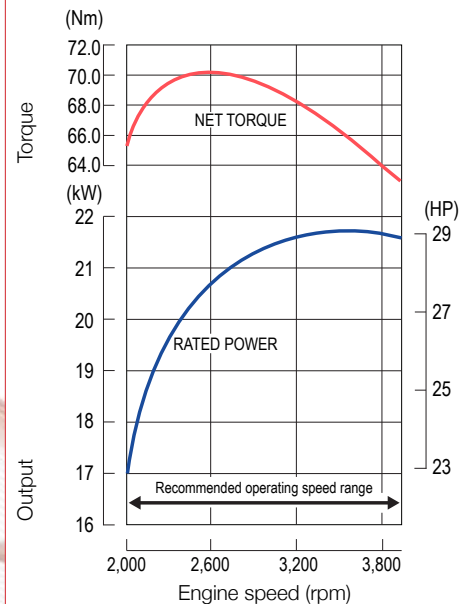
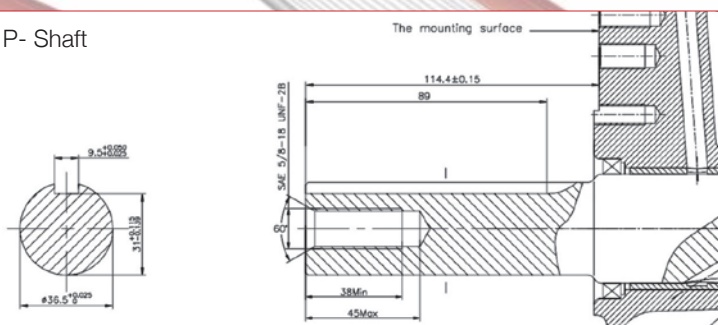

Think Petrol, Think Repower, Think Loncin

The Loncin Engine Series offers a cost effective option for the repower market.

- Horizontal shaft engines from 1.8 hp to 12 hp
- Vertical engines from 3.6 hp to 4.8 hp
- V-Twin 29.5 hp horizontal and 19.3 hp vertical engines

Features and Benefits

- Durable
- High performance
- Electric start optional
- Low noise
- Fuel efficient
- Standard engine drive shafts
- Standard mounting points



Construction

Plant and Tool



Cement Mixers

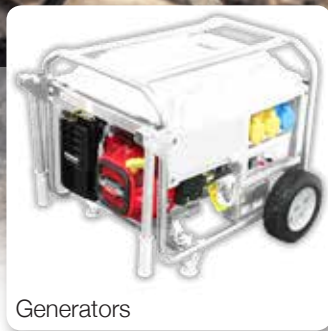

Generators

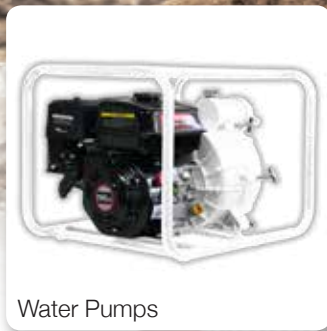

Water Pumps



Vibration Plate

Ground Care / Utility

Leisure



Rotavator



Pressure Washers

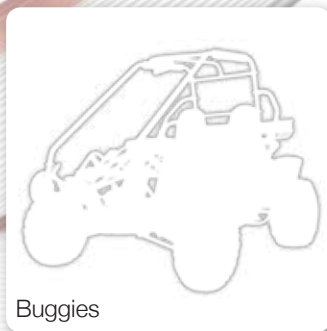

Buggies



Go-Kart

International Cooperation

Motorcycle cooperation with BMW since 2005 offers Loncin a a very advanced quality control system. Loncin also have ODM cooperation with well-known international companies.



makes a difference



Price List

MODEL	DESCRIPTION	EX VAT	INC VAT @ 20%
Single Cylinder Horizontal			
LC152F	1.8hp 5/8" parallel shaft, oil alarm, recoil start, repower	£120.83	£144.99
LC152F-M	1.8hp 15mm parallel shaft, oil alarm, recoil start, repower	£120.83	£144.99
LC154F	2.1hp 16mm parallel shaft, recoil start, repower	£129.16	£154.99
G120F-P	3.5hp 3/4" parallel shaft, oil alarm, recoil start, repower	£148.33	£177.99
G120F-M	3.5hp 18mm parallel shaft, oil alarm, recoil start, repower	£148.33	£177.99
G160F-B	4.8hp 2:1 reduction gearbox, oil alarm, recoil start, repower	£231.66	£277.99
G160F-P	4.8hp 3/4" parallel shaft, oil alarm, recoil start, repower	£149.99	£179.99
G160F-M	4.8hp 20mm parallel shaft, oil alarm, recoil start, repower	£149.99	£179.99
G200F-P	5.5hp 3/4" parallel shaft, oil alarm, recoil start, repower	£154.16	£184.99
G200F-G	5.5hp taper shaft, oil alarm, recoil start, repower	£154.16	£184.99
G200F-M	5.5hp 20mm parallel shaft, oil alarm, recoil start, repower	£154.16	£184.99
G200F-B	5.5hp 2:1 reduction gearbox, oil alarm, recoil start, repower	£245.83	£294.99
G200F-EP	5.5hp 3/4" parallel shaft, oil alarm, electric/recoil start, repower	£227.49	£272.99
G240F-P	7hp 1" parallel shaft, oil alarm, recoil start, repower	£310.83	£372.99
G270F-B	8hp 2:1 reduction gearbox, oil alarm, recoil start, repower	£391.66	£469.99
G270F-P	8hp 1" parallel shaft, oil alarm, recoil start, repower	£295.83	£354.99
G270F-EP	8hp 1" parallel shaft, oil alarm, electric/recoil start, repower	£379.16	£454.99
G340F-G	10hp taper shaft, oil alarm, recoil start, repower	£333.33	£399.99
G340F-P	10hp 1" parallel shaft, oil alarm, recoil start, repower	£333.33	£399.99
G340F-EP	10hp 1" parallel shaft, oil alarm, electric/recoil start, repower	£429.16	£514.99
G390F-P	11hp 1" parallel shaft, oil alarm, recoil start, repower	£329.16	£394.99
G390F-EP	11hp 1" parallel shaft, oil alarm, electric/recoil start, repower	£402.49	£482.99
G390F-G	11hp taper shaft, oil alarm, recoil start, repower	£324.99	£389.99
G420F-EP	12hp 1" parallel shaft, oil alarm, electric/recoil start, repower	£418.33	£501.99
G420F-EG	12hp taper shaft, oil alarm, electric/recoil start, repower	£418.33	£501.99
Single Cylinder Vertical			
LC1P61FA	3.6hp 7/8" vertical shaft, recoil start, repower	£141.66	£169.99
LC1P65FA	4hp 7/8" vertical shaft, recoil start, repower	£145.83	£174.99
LC1P68FA	4.6hp 7/8" vertical shaft, recoil start, repower	£154.16	£184.99
LC1P70FA	4.8hp 7/8" vertical shaft, recoil start, repower	£158.33	£189.99
LC1P88FA	11.5hp 7/8" vertical shaft, recoil start, repower	£499.99	£599.99
Twin Cylinder Horizontal			
LC2V78FD-1	19.7hp 1" parallel shaft, v-twin + muffler & electric start, repower	£895.83	£1,074.99
LC2V90FD-1	29.5hp Taper Shaft, v-twin + muffler & electric start, repower	£1,515.83	£1,819.00
Twin Cylinder Vertical			
LC2P80F	19.3hp 1" vertical shaft, v-twin + muffler & electric start, repower	£820.83	£984.99
Pumps			
LC25ZB21-1.2Q	1" water pump	£154.16	£184.99
LC50ZB23-3.1Q	2" water pump	£198.33	£237.99
LC50ZB60-4.5Q	2" high lift water pump	£337.49	£404.99
LC80ZB35-4.5Q	3" water pump	£229.16	£274.99
LC80WB30-4.5Q	3" semi trash pump	£354.16	£424.99
LC50HZB23-3.1Q	2" chemical pump	£331.82	£398.18
Generators			
LC2000i	1.6kW 2000i inverter suitcase genset (standard)	£624.99	£749.99
LC2000i-S	1.6kW 2000i inverter suitcase genset (synchronising)	£649.99	£779.99
LC2000i-S-110V	1.6kW 2000i inverter generator 110v	£666.66	£799.00
LC3500i-S	3kW 230v, 3 pin inverter suitcase genset (synchronising)	£1,083.33	£1,299.99
LC3500iO	3kW 230v, open frame generator (synchronising)	£833.33	£999.99
LC3500iO-110V	3kW 110v, open frame generator (synchronising)	£833.33	£999.99
LC2500-AS	2kW open frame generator	£362.49	£434.99
LC3000-AS	2.3kW open frame generator	£395.83	£474.99
LC5000D-A	4kW open frame generator, electric start, with wheel kit	£779.16	£934.99
LC6500D-A	5kW generator, electric start, with wheel kit	£805.83	£966.99
LC8000D-A	6kW generator, electric start, with wheel kit	£874.99	£1,049.99
Optional			
RDG2068652	Generator earth rod 3/8" x 4'	£12.50	£15.00
RDG2068653	Generator earth lug	£12.00	£14.40

Please note that it is responsibility of the user to ensure that generating sets are correctly earthed prior to use. If unsure please contact a qualified electrician.

POWERING THE FUTURE



TWO YEAR WARRANTY ON ALL LONCIN PRODUCTS



E. P. Barrus Ltd., Glen Way, Launton Road, Bicester, Oxfordshire, OX26 4UR
t: 01869 363606 f: 01869 363667 e: loncin@barrus.co.uk w: loncinuk.com
E. P. Barrus Ltd. reserves the right to change specifications and/or prices without notice.



CELEBRATING OUR FIRST 100 YEARS.
GEARING UP FOR THE NEXT.